

9400 Cooling Fan, Rotary Screen, Air Conditioning, Clean Grain Elevator, Cylinder Intermediate Drive, Cylinder Drive and Lower Tailings Auger and Elevator

Key	Qty.	Serial No.	Part No.	Description
1	1		H132809	Cooling fan
2	1	(-640505)	H143869	Rotary screen
	1	(640506-)	H145158	Rotary screen
3	1	(-640505)	H134216	Rotary screen drive
	1	(640506-)	H146636	Rotary screen drive
4	1	(630201-635100)	H134772	Air conditioning compressor
	1	(635101-636600)	H101813	Air conditioning compressor
	1	(650101-)	H80896	Air conditioning compressor
5	1	(-640100)	H137830	Clean grain elevator
	1	(640101-)	H141167	Clean grain elevator
6	1		H210476	Cylinder intermediate drive
	1		H137670	For extended range
7	1		H115881	Cylinder drive regular dual range and single range
	1		H145994	For extended range
8	1		N110085	Lower tailings auger and elevator

9500, 9500 Sidehill

Key	Qty.	Serial No.	Part No.	Description
1	1		H153297	Cooling fan, high power
	1		H132808	Cooling fan, low power (9500)
2	1	(-642578)	H143869	Rotary screen
	1	(642579-)	H145158	Rotary screen
3	1	(-642578)	H134216	Rotary screen drive
	1	(642579-)	H146636	Rotary screen drive
4	1	(630301-631100)	H134437	Air conditioning compressor (9500)
	1	(635201-648500)	H81742	Air conditioning compressor
	1	(650201)	H80896	Air conditioning compressor
5	1	(-640200)	H137830	Clean grain elevator
	1	(640201-)	H141167	Clean grain elevator
6	1		H210476	Cylinder intermediate drive
7	1		H115881	Cylinder drive regular dual range and single range
	1		H118618	Cylinder drive slow speed
8	1		N110085	Lower tailings auger and elevator

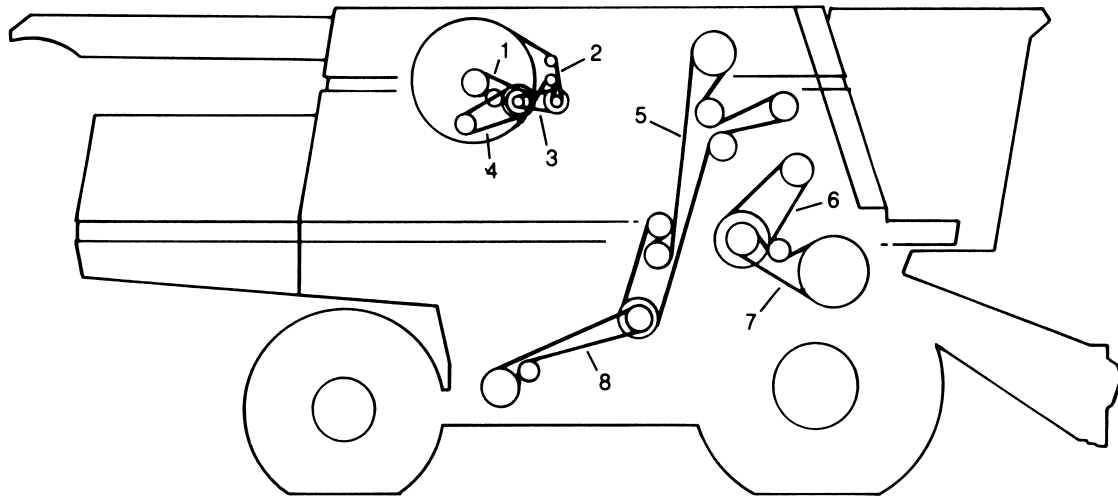

9600 Cooling Fan, Rotary Screen, Air Conditioning, Clean Grain Elevator, Cylinder Intermediate Drive, Cylinder Drive and Lower Tailings Auger and Elevator

Key	Qty.	Serial No.	Part No.	Description
1	1	(-641716)	H132808	Cooling fan
2	1	(641717-)	H153297	Cooling fan
	1	(-641716)	H143869	Rotary screen
	1	(641717-)	H145158	Rotary screen
3	1	(-641921)	H133577	Rotary screen drive
	1	(641922-)	H146636	Rotary screen drive
4	1	(-631200)	H134437	Air conditioning compressor
	1	(631201-647500)	H81742	Air conditioning compressor
	1	(647501-)	H80896	Air conditioning compressor
5	1		H135458	Clean grain elevator
	1	(640301-)	H141166	Clean grain elevator
6	1		H210476	Cylinder intermediate drive
7	1		H115881	Cylinder drive regular dual range and single range
	1		H118618	Cylinder drive slow speed
8	1		N110085	Lower tailings auger and elevator

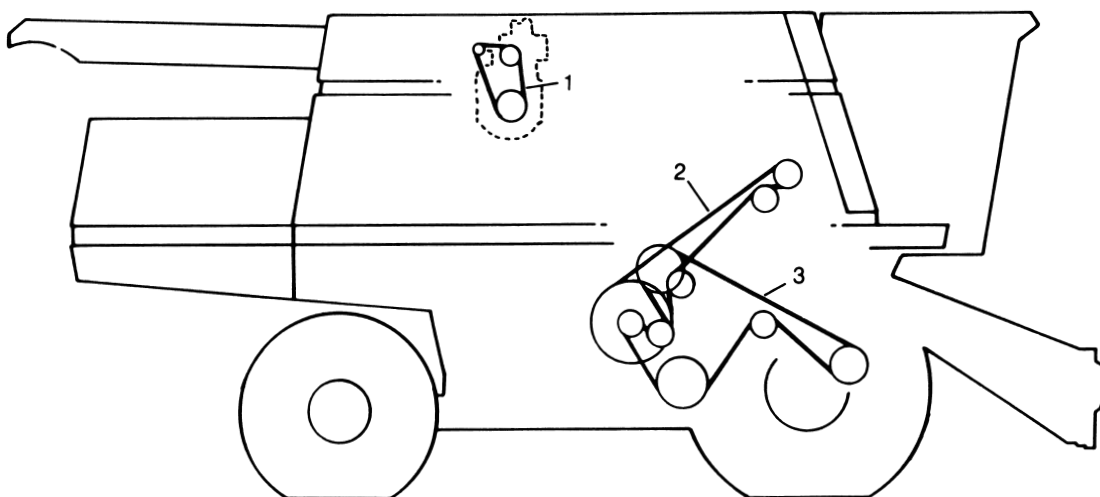

9400 | **Alternator, Secondary Countershaft, Shoe, Straw Walker and Conveyor Augers**

Key	Qty.	Serial No.	Part No.	Description
1	1	(-635100)	RE44538	For alternator (matched set of 2)
	1	(635101 -)	H101813	For alternator
2	1		H128010	Secondary countershaft
3	1		H131169	Shoe, straw walker and conveyor augers

9500, 9500 Sidehill |

Key	Qty.	Serial No.	Part No.	Description
1	1		H134344	For alternator
	1	(635201 -645200)	R73189	For alternator
	1	(645201 -)	H101813	For alternator
2	1		H128010	Secondary countershaft
3	1		H131169	Shoe, straw walker and conveyor augers

9600 |

Key	Qty.	Serial No.	Part No.	Description
1	1	(-631200)	RE44538	For alternator
	1	(631201 -)	H101813	For alternator
2	1		H128010	Secondary countershaft
3	1		H131169	Shoe, straw walker and conveyor augers

COMBINES — 9400, 9500, 9500 SIDEHILL, 9600 (continued)

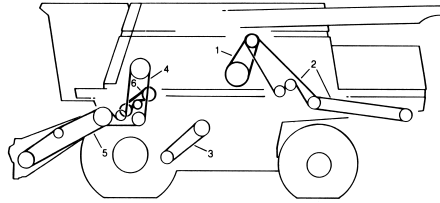
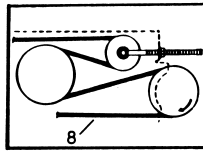
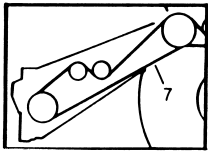

9400

Beater Drive, Unloading System, Header and Reel Pump, Unloading Augers, Feeder House, Straw Spreader

Key	Qty.	Serial No.	Part No.	Description
1	1		AH158880	Unloading system
2	1		H125380	Front
	1		E46113	Chopper in windrow or forward position
	1		H101436	Chopper in rear (operating) position
3	1		H140404	Regular speed
	1		H137264	Slow speed
4	1	(-635100)	H125565	Header and reel pump
	1	(635101 -)	H151952	Header and reel pump
5	1		H161648	Variable speed feeder house
6	1		AH139436	Beater drive (100 percent)
	1		AH163931	Beater drive (75 percent)
7	1		H126345	Fixed speed feeder house with reverser
8	1		Z33774	Straw spreader

**9500,
9500 Sidehill**

Key	Qty.	Serial No.	Part No.	Description
1	1		AH158880	Unloading system
2	1		H125380	Front
	1	(-640200)	P47885	Chopper in windrow or forward position (9500)
	1	(640201 -)	H23950	Chopper in windrow or forward position
	1		H125381	Chopper in rear (operating) position
3	1		H140404	Regular speed (750-1,350 RPM)
	1		H137264	Slow speed (490-980 RPM)
4	1	(-635200)	H125565	Powershaft and reel pump (9500)
	1	(635201 -)	H151952	Powershaft and reel pump
5	1		H161648	Variable speed feeder house
6	1		AH139436	Beater drive (100 percent)
	1		AH163931	Beater drive (75 percent)
7	1		H126345	Fixed speed feeder house with reverser
8	1		H128234	Straw spreader

9600

Key	Qty.	Serial No.	Part No.	Description
1	1		AH158880	Unloading system
2	1		H125380	Front
	1		H23950	Chopper in windrow or forward position
	1		H125381	Chopper in rear (operating) position
3	1		H140404	Regular speed
	1		H137264	Slow speed
4	1	(-635300)	H125565	Powershaft and reel pump
	1	(635301 -)	H151952	Powershaft and reel pump
5	1		H161648	Variable speed feeder house
6	1		AH139436	Beater drive (100 percent)
	1		AH163931	Beater drive (75 percent)
7	1		H126345	Fixed speed feeder house with reverser
8	1		H128234	Straw spreader