

Alternator, Secondary Countershaft, Feeder Conveyor, Shoe, Straw Walker and Conveyor Augers

Key	Qty.	Serial No.	Part No.	Description
1	1		H101813	For alternator
2	1		H128010	Secondary countershaft, 19 mm (3/4-in.) pitch, 219 links
3	1		H131169	Shoe, straw walker and conveyor augers

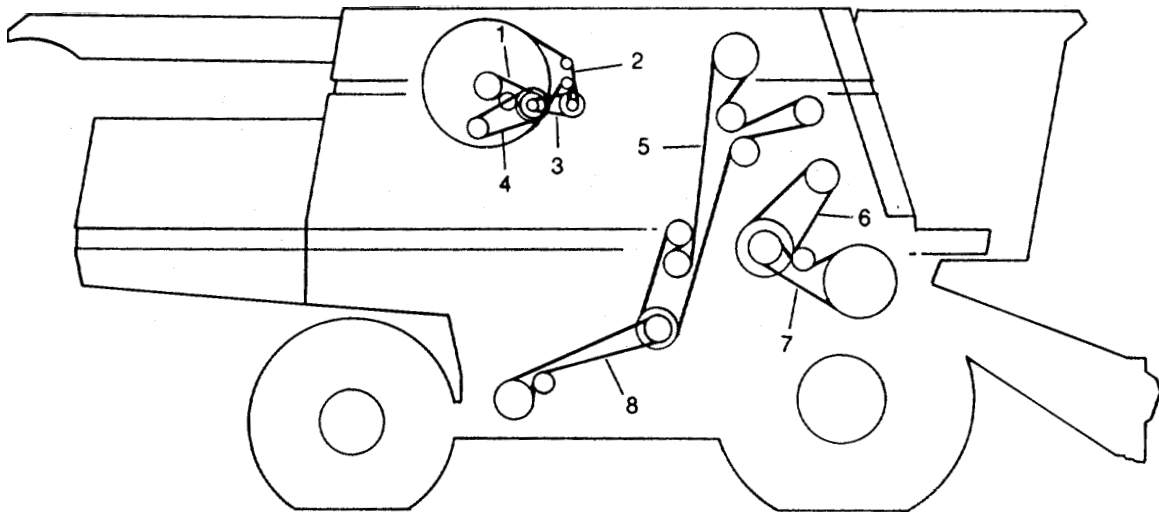

Cooling Fan, Rotary Screen, Air Conditioning, Clean Grain Elevator, Cylinder Intermediate Drive, Cylinder Drive and Lower Tailings Auger and Elevator

Key	Qty.	Serial No.	Part No.	Description
1	1		H160405	Cooling fan
2	1		H145158	Rotary screen
3	1		H146636	Rotary screen drive
4	1		H134437	Air conditioning compressor
5	1		H160171	Clean grain elevator
6	1		H210476	Cylinder intermediate drive
7	1		H115881	Cylinder drive regular dual-range and single-range
	1		H118618	Cylinder drive slow speed
8	1		N110085	Lower tailings auger and elevator

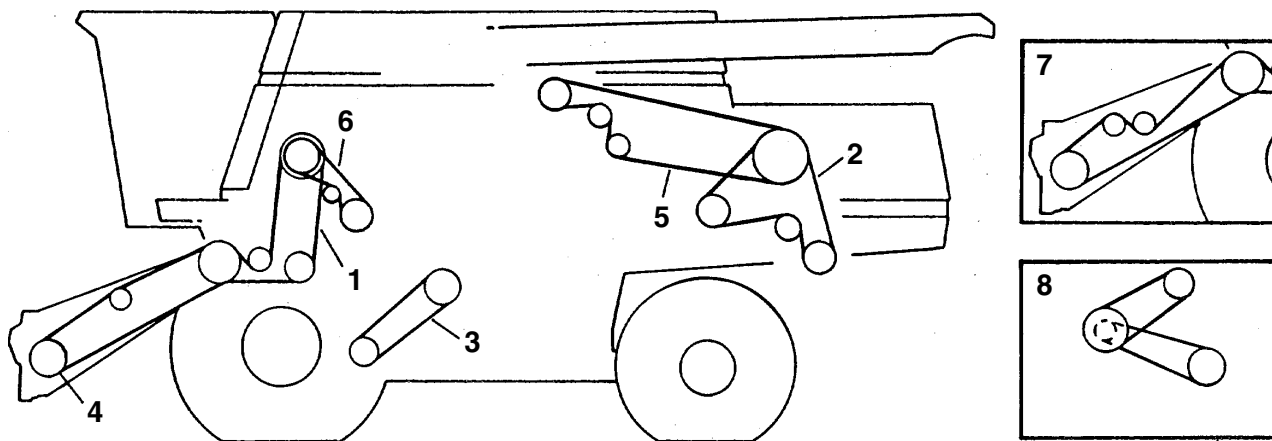

Header and Reel Pump, Unloading Augers, Straw Chopper, Cleaning Fan, Feeder House and Straw Spreader (Left-Hand Side)

Key	Qty.	Serial No.	Part No.	Description
1	1		H151952	Front end equipment
2	1		H168301	Straw chopper (standard)
	1		H155525	Straw chopper (fine cut)
3	1		H140404	Regular (750-1,350 RPM) fan drive
	1		H137264	Slow speed (490-980 RPM)
4	1		H161648	Variable speed
5	1		H141429	Separator
6	1		H143700	Beater drive
7	1		H126345	Fixed speed feeder house
8	1		E61326	Straw spreader (upper)
	1		P49604	Straw spreader (lower)
	1		M140021	Chaff spreader drive

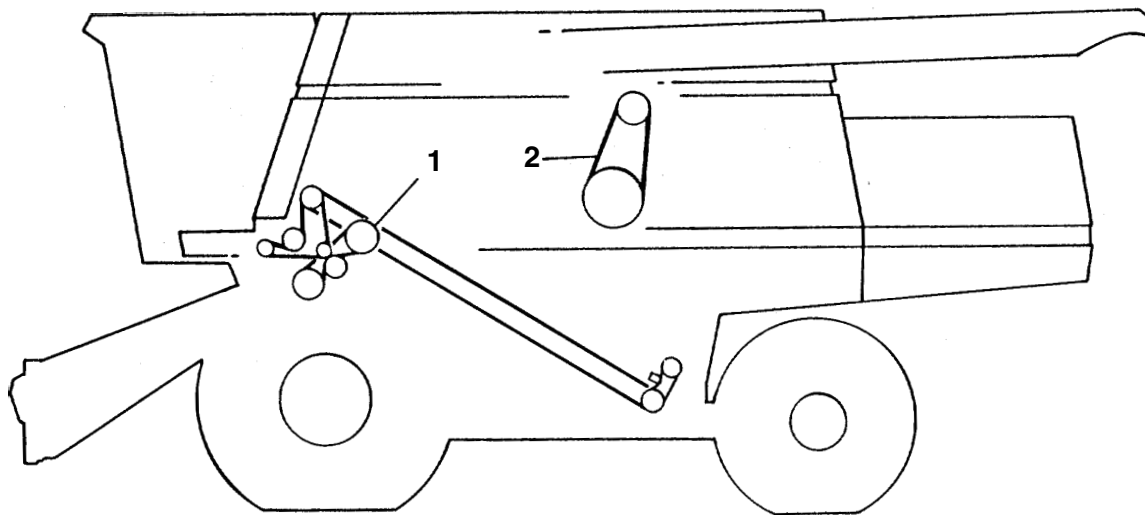

Tailings Auger, Beater and Unloading System Belts and Chains (Left-Hand Side)

Key	Qty.	Serial No.	Part No.	Description
1	1		H139963	Stripper beater
2	1		AH158880	Unloading system